

Wyoming Certified Land Corner Recordation Certificate

This form is to be completed in accordance with W.S. 36-11-101, printed in black ink or typed, and shall be for one individual corner.

Describe below, or show in sketch attached to this form, the corner evidence found. Include condition and type of monument, accessories and ties. Describe any maintenance or rehabilitation performed. In the circle to the right, show monument inscription. If monument is determined lost or obliterated, restate the GLO or BLM original field note record; describe or show the procedure used to reestablish the corner and all data as above for a found monument.

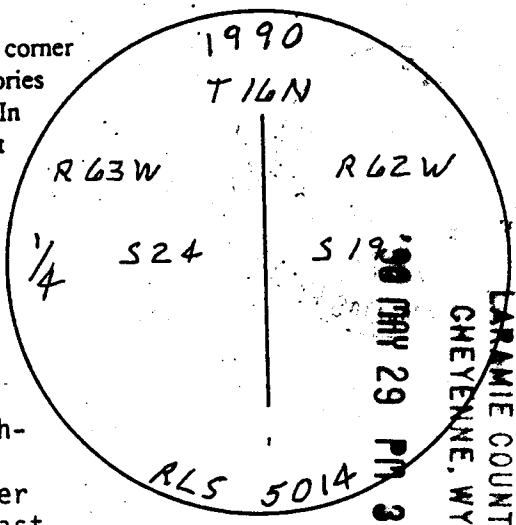

Field Date 4-13-90 Office Reference _____

After extensive field search, it was determined the best evidence for the re-establishment of the corner was the straight-line proportion between the found southeast corner of Section 24 and the re-established northeast corner of Section 24.

GLO notes attached.

Monument set: #5 rebar with 2" aluminum cap stamped as shown; 6" below gravel road.

References: P-K nails with 1-1/2" galvanized washers stamped "5014".

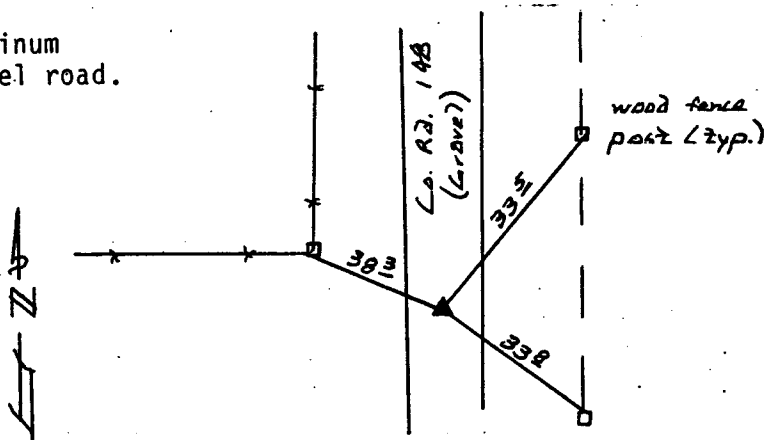

State of Wyoming
Office of County Clerk
County of Laramie

This Certified Land Corner Recordation Certificate was filed for record on the _____ day of _____, 19 __, in Book No. T _____, R _____, on Alpha-Numeric coordinates P1 and was noted on the Cross Index Plat.

County Clerk

Corner Type: Aliquot Corner Other

Section(s) 19 Meridian 6th

Corner Name Quarter Township 16 N Range 62 W Page _____

Sheet 1 of 3

1593

1175

Directions for using the Cross Index Plat

Section, quarter and sixteenth corners will be marked with a dot at the corner location. The alpha-numeric coordinate number is then determined for the intersection of the two lines. A corner that applies to two or more townships shall be filed under all that apply by the use of photo copies.

Closing corners will be indexed under the township in which they control ownership. For 1/64, 1/256, 1/1024 and non-aliquot corners lying between grid designations, mark the appropriate grid area with a dot and use the index code to the north and west (local systems may be used if the method is approved by the County Surveyor or Clerk and a written description of its use is filed in the front of each book of certificates).

Cross Index Plat

	1	2	3	4	5	6	7	8	9	10	11	12	13	14	15	16	17	18	19	20	21	22	23	24	25	
A																										
B																										
C																										
D																										
E																										
F																										
G																										
H																										
I																										
J																										
K																										
L																										
M																										
N																										
O																										
P																										
Q																										
R																										
S																										
T																										
U																										
V																										
W																										
X																										
Y																										
Z																										
	1	2	3	4	5	6	7	8	9	10	11	12	13	14	15	16	17	18	19	20	21	22	23	24	25	

State Plane Coordinates (optional)

Zone W WC EC E feet/meters

NAD 1927 NGVD 1929 NAD 1983 NAVD 1988

North (Y) = _____ East (X) = _____ EL = _____

Latitude _____ Longitude _____

Scale Factor _____ Geoid Height _____

Certification

I, Raymond E. Connin, Wyoming PLS-PEXX 5014 certify that I, or others under my supervision, have performed the work as described above and completed this form.

Company or Agency Hall & Walters, Inc.

Mailing Address _____

Street Address 873 North Cleveland

City, State, ZIP Loveland, CO 80537

Telephone, FAX 303-663-1177

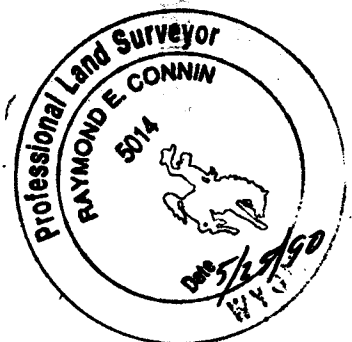

Raymond E. Connin
Signature, Seal, and Date

156 North between Ranges 62 x 63
 chains
 Sand mostly level valley
 Soil sandy loam
 Vegetation. Buffalo Grass
 May 18. 1871

From the corner to Towns
 157 16 N. Ranges 62 x 63
 & run
 North between Ranges 62 x
 along E. bound. Sec. 36.

Var. 15 = 27' E.
 8000 set Limestone 15 x 10 x 4 ft
 1/4 sec. cor.
 8000 set Limestone 18 x 13 x 4
 for corner to Sec. 25-36-
 20 x 1
 Land rough and broken
 Soil sandy and gravelly
 Good growth of grass

157 From 16 N.
 chains
 N. along E. bound. Sec. 25
 Va. 15 = 27' E.

8000 set Limestone 14 x 9 x 5 for
 1/4 sec. cor.
 8000 set Limestone 15 x 10 x 4 for
 corner to Sec. 24-25-19 x 20
 Land rolling and rough
 Soil sandy. Vegetation
 Buffalo Grass

North along E. bound. Sec. 24
 Va. 15 = 25' E.
 8000 set Limestone 15 x 10 x 4
 for 1/4 sec. cor.
 8000 set Limestone 15 x 11 x 5
 for corner to Sec. 13-24
 18 x 19
 Land rolling sandy soil
 Vegetation, Buffalo Grass



Handwritten marks and scribbles in the top right corner.